



GRAPHIC PRODUCTS, INC.

Tools for the Art of Framing

www.logangraphic.com

SIMPLEX V-GROOVER

MODEL 703

INSTRUCTION AND OPERATION MANUAL

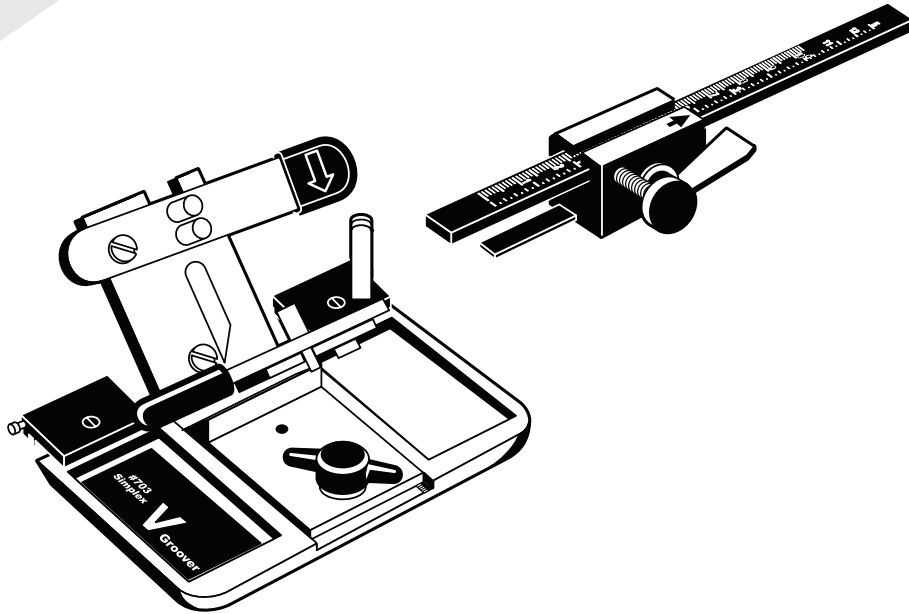

**For best results use only
authentic Logan blades**

CAUTION: BLADES EXTREMELY SHARP

Use replacement blades #1258

Logan Graphic Products, Inc.
1100 Brown Street
Wauconda, IL 60084
Phone (847) 526-5515 Fax (847) 526-5155
Toll Free (800) 331-6232

L1272 3/05

V-GROOVER HEAD

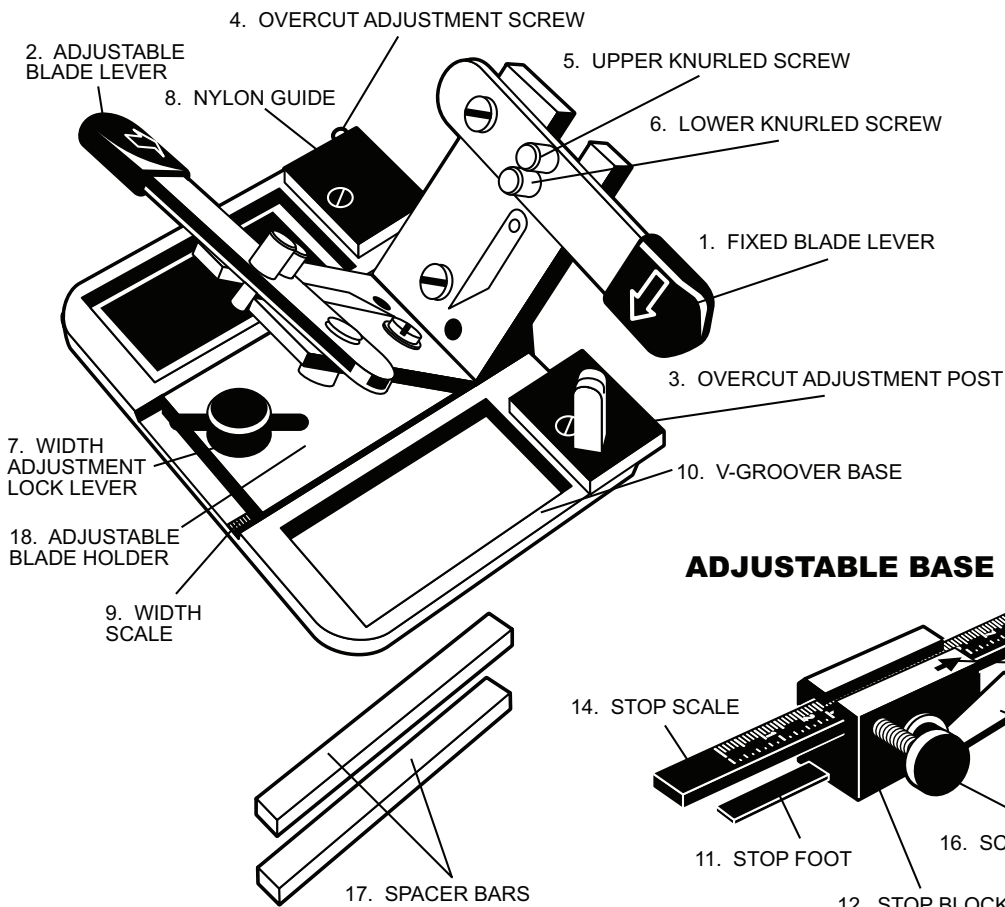

Contents of the Model 703 Simplex V-Groover Carton

- 1 V-Groover head
- 2 Adjustable stop
- 3 Two 1/2" spacer bars
- 4 Five pieces of sample mat board
- 5 Six Logan #1258 blades
- 6 Fully illustrated instruction manual

ADJUSTABLE BASE

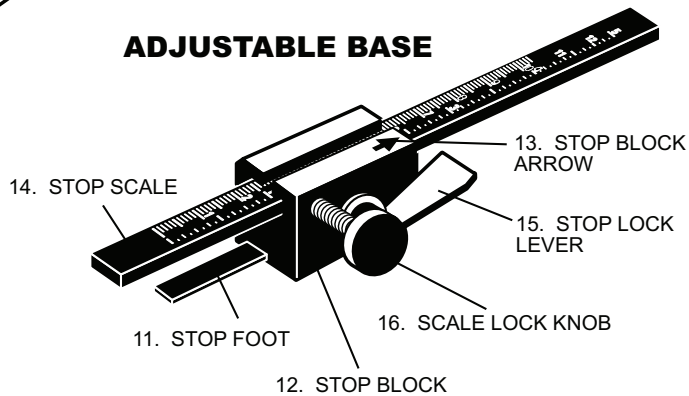

Explanation of Parts

- 1&2 Fixed Blade/Adjustable Blade Levers - Levers used to insert and remove blades for cutting V-Groove.
- 3&4 Overcut Adjustment Screw/Post - Screws used to fine tune overcut amounts. Screws take #1 straight edge screwdriver.
- 5&6 Upper and Lower Knurled Screws - Located on the levers, these screws hold the blade in position for cutting.
- 7 Width Adjustment Lock Lever - When loosened, allows for adjustment of V-Groove width from 1/32" to 5/64".
- 8 Nylon Guide
- 9 Width Scale
- 10 V-Groover Base
- 11 Stop Foot - Used to position stop at end of mat board.
- 12 Stop Block
- 13 Stop Block Arrow
- 14 Stop Scale
- 15 Stop Lock Lever - Used to lock stop in position on guide rail.
- 16 Scale Lock Knob - Knob which allows adjustment of scale.
- 17 Spacer Bars - Aluminum spacers used against mat guide to compensate for offset blade location.
- 18 Width Adjustment Blade Holder - Blade holder which slides to adjust V-Groove width.

Introduction to the Model 703 Simplex V-Groover

The Logan model 703 Simplex V-Groover uses a unique and innovative procedure to cut V-Groove mats. It is important to recognize certain principles of the procedure before reading the instructions:

- 1 All V-Grooving is done on the surface of the mat with measuring stops so there is no need to mark the mat.
- 2 To ensure proper usage of the cutter, all V-Grooves must be cut before cutting window with mat cutter.
- 3 Due to variations in Simplex Mat Cutter calibration, it will probably be necessary to adjust overcuts on V-Groover until correct.
- 4 V-Groover will cut 1/2" away from the rail - not next to it as does the Bevel Head (#702)
- 5 Always work from end of Simplex machine for easiest operation of V-Groover.

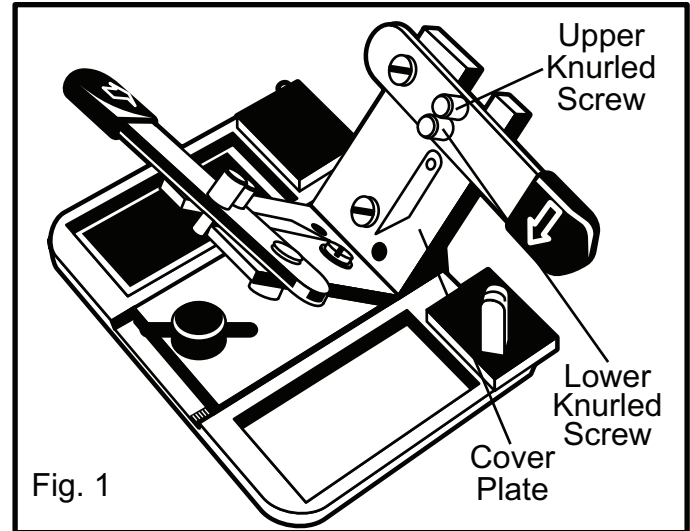

Preparation for V-Grooving

Installing Blades

- 1 Start on either side. Loosen upper and lower knurled screws 3 full turns (Fig. 1).
- 2 Insert blade into blade holder slot on reverse side of the cover plate, with the blade point facing the same direction as the design on the cover plate (Fig. 1 & 2).
Note: If blade hits knurled screw tips, loosen an additional turn until blade is able to slide into slot easily.
- 3 Insert the blade so the round end is past the upper knurled screw (Fig. 3).
- 4 Pull blade top back against upper knurled screw.
- 5 Next, tighten lower knurled screw.
- 6 Repeat procedure for the opposite side.

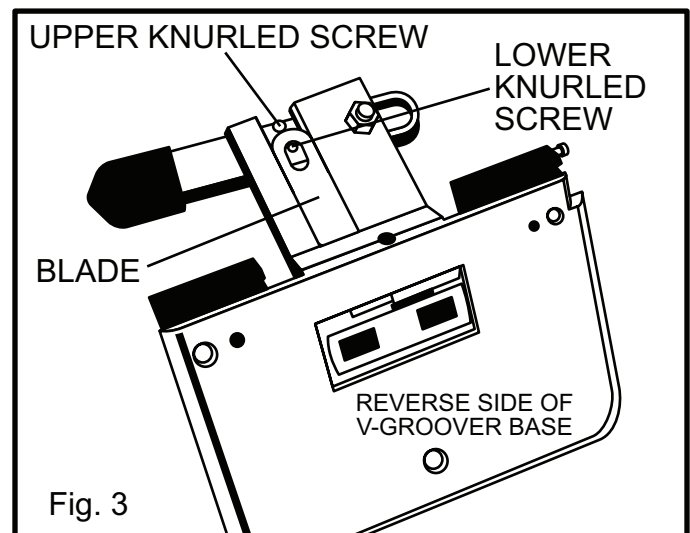
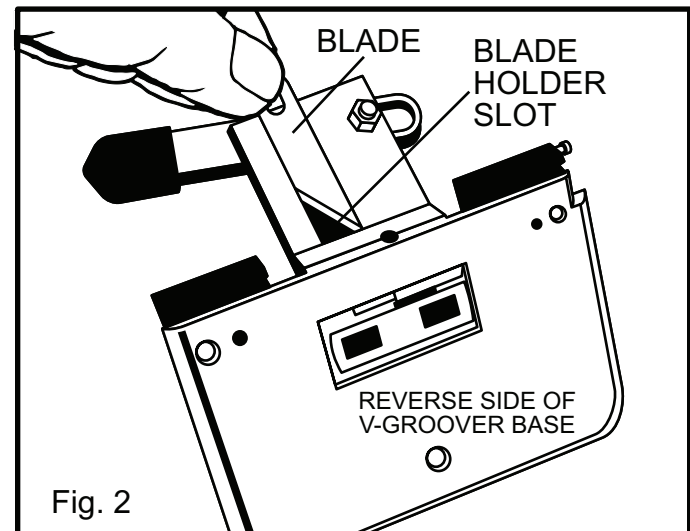

Please Note

The Logan Simplex V-Groover requires a Logan #1258 blade. These blades are specially ground for use in this V-Groover. No other blades will work.

Preparation to Cut a V-Groove

For our example we will be cutting a V-Groove 2" from the edge of the mat board

Note: Spacer bars are used to compensate the scale because the V-Groover cuts 1/2" away from the guide rail - not next to it as does the bevel head.

Setting Stops

Setting Squaring Arm Stop or Mat Guide

Option A - Using the Spacer Bar

- 1 Set stop or mat guide at desired V-Groove dimension. For our example set at 2"
- 2 Place spacer bar against squaring arm stop or mat guide (Fig. 4).

Note: Be sure the spacer bars are lying flat.

Option B - Making Setting Without Spacer Bars

- 1 Set mat guide 1/2" less than desired V-Groove dimension. For our example, 2" less 1/2" is equal to 1 1/2". Set at 1 1/2".

Setting Guide Rail Stop

- 1 Set guide rail stop at desired V-groove dimension. For our example, set guide rail stop at 2" (Fig. 5).

Setting V-Groove Stop

- 1 Insert mat board color side up on to backing sheet. Press mat firmly against squaring arm and spacer bars.
- Note: On model SGM, if mat guide is set less than 2", use two pieces of backing sheet.*
- 2 Lower guide rail on to mat.
- 3 Install V-Groover stop on to guide rail by turning stop lock lever back against scale lock knob (Fig. 6) and fitting clamp plate over outer lip of guide rail (Fig. 7). Slide v-stop beyond end of mat board and slide back until v-stop foot contacts mat board end. Tighten stop lock lever by pressing clockwise until snug (Fig. 8).
- 4 To set v-stop scale, loosen scale lock knob. Slide stop scale to desired setting at v-block arrow and tighten scale lock knob. For our example set scale at 2" (Fig.8).

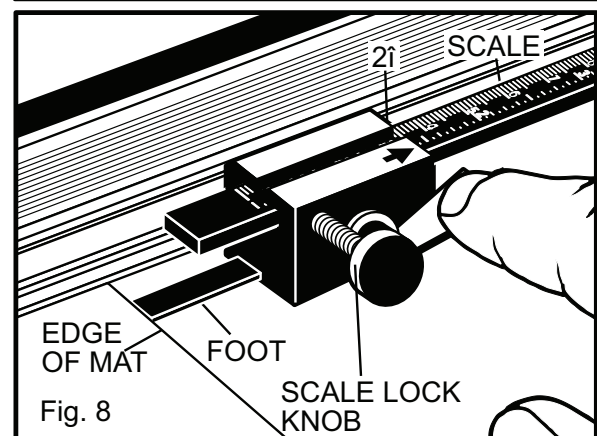
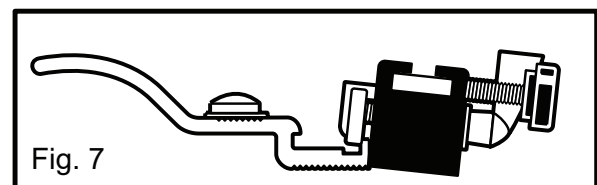
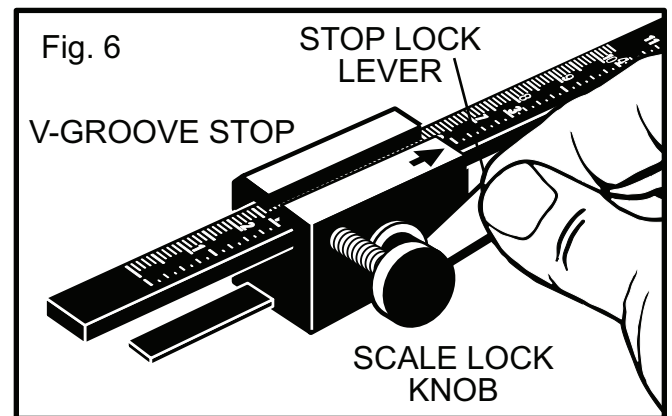
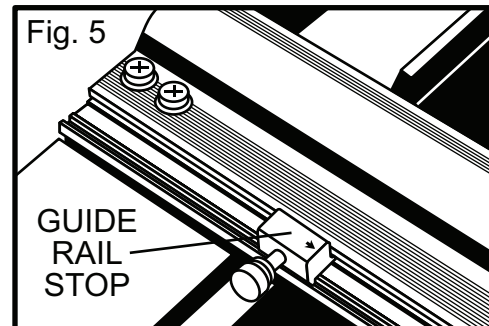
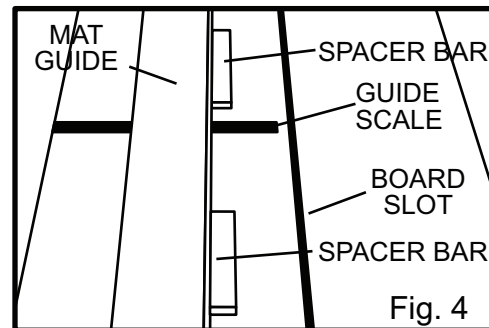

Cutting the V-Groove

To make the process faster, it is recommended that both long sides of V-Groove are cut first, then both short sides, to eliminate the need to re-adjust V-Groove stop 4 separate times.

Cutting Long Sides

- 1 Install V-Groove cutting head by hooking nylon guides over outer lip of guide rail.
- 2 Slide cutting head back toward you against guide rail stop.
- 3 With left hand, place thumb on V-Groove lever and place index and middle fingers on front of base (Fig. 9).
- 4 With left hand, depress fixed blade lever handle and hold down (Fig. 9).

Note: Be sure opposite blade lever is up or it will tear board surface.

- 5 Keeping firm downward pressure with both hands, gently push cutting head toward V-Groove stop until overcut adjustment post contacts stop scale (Fig. 10).

Do not ram overcut adjustment post into stop scale!

- 6 Lift fixed blade lever handle up to remove blade. With left hand, depress adjustable blade lever handle and hold down (Fig. 11). Keeping firm downward pressure with both hands, pull the cutting head back to the guide rail stop until overcut adjustment screw contacts the stop.
- 7 Lift adjustable blade lever handle up to remove blade.
- 8 Lift guide rail and turn mat 180°. Slide back against squaring arm and spacer bars (option A) or squaring arm stop (option B) or mat guide (option B).
- 9 Lower guide rail onto mat.

Please note: Be sure v-stop foot is resting firmly against mat board end (as in Fig. 8), and not on top of the mat. Re-adjust if necessary.

- 10 Repeat procedures 3 thru 7.

Cutting Short Sides

- 1 Lift guide rail and turn mat 90°. Slide back against squaring arm and spacer bars (option A) or mat guide (option B)
- 2 Lower guide rail onto mat.
- 3 Reset v-stop by loosening stop lock lever and sliding back until v-stop foot contacts mat board end. Hold block and tighten lever.
- 4 Repeat the same procedure described earlier to cut long sides.

Please note: As you cut the last side, mat scraps may begin to come out of the mat. Simply hold them down in mat while cutting or carefully tear off 1/4" from corner.

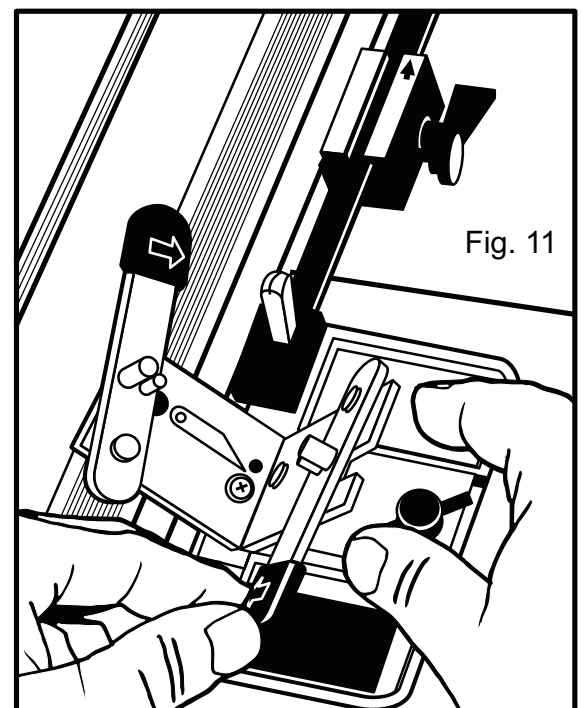
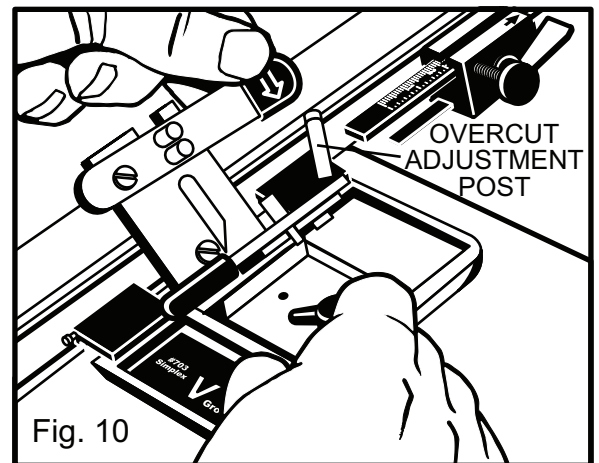
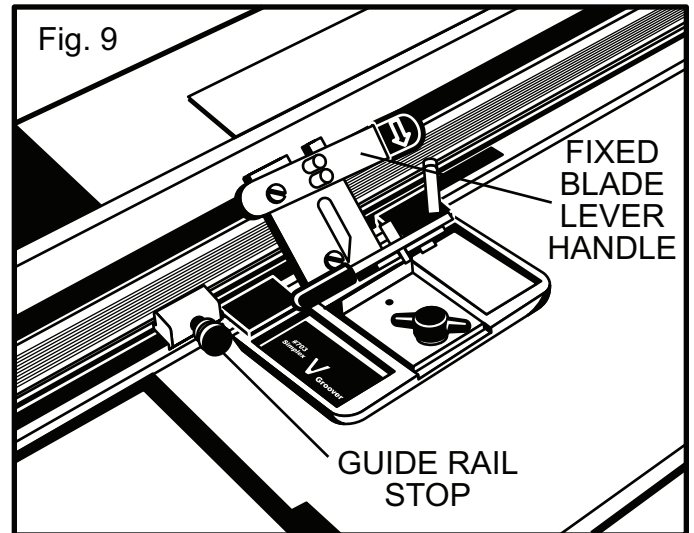

Adjustments

V-Groove Width Adjustments

To adjust width, loosen the width adjustment lock lever turning counterclockwise. Slide adjustable blade holder to desired width setting. Tighten lever to lock. Use width scale as a reference. (Maximum V-Groove width setting is 5/64" - minimum width is 1/32"). Fig 12.

Overcut Adjustment

- 1 Overcut Adjustment Screw:
 - a. Turn screw clockwise to increase overcut (Fig. 13).
 - b. Turn screw counterclockwise to decrease overcut (Fig. 13).
- 2 Overcut Adjustment Post:
 - a. To adjust for longer overcut, visually note overcut adjustment post (by looking straight down at post) and turn post from under side with screwdriver toward position shown in Fig. 14.
 - b. To shorten overcut, turn overcut adjustment post toward position shown in Fig. 15.

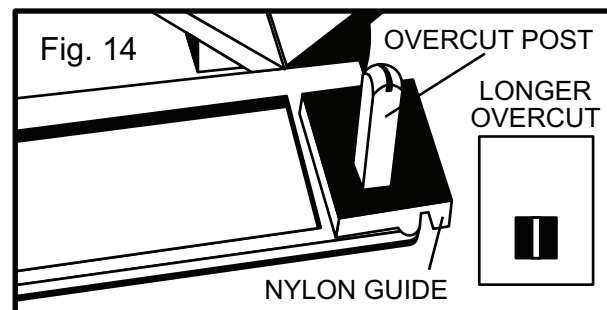
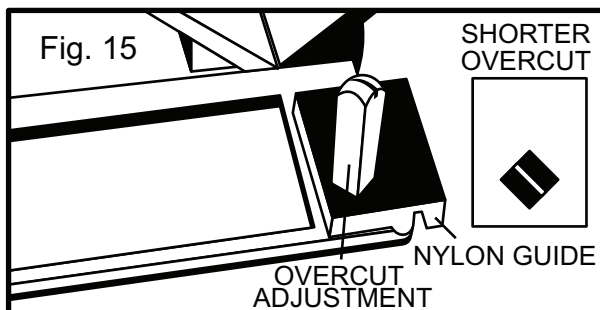
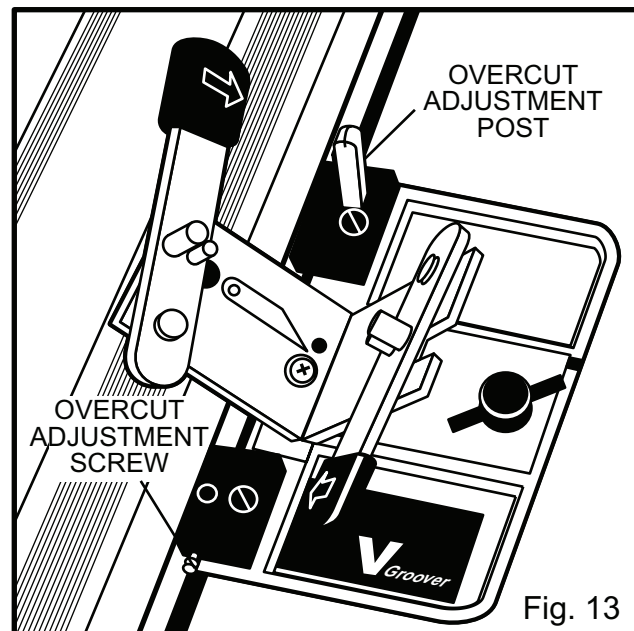
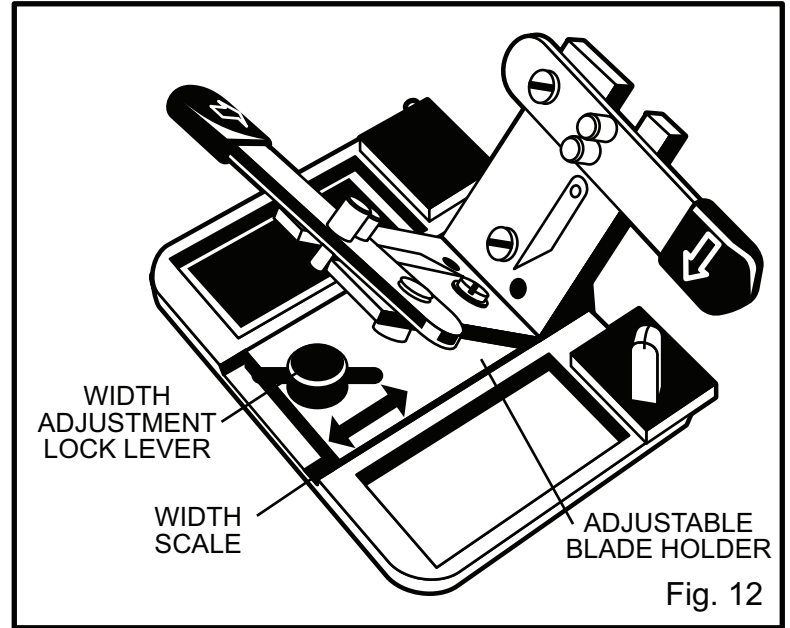



Important Facts - Helpful Hints

- 1 Always be sure opposite lever is up while cutting, or blade may scratch mat board surface.
- 2 While cutting, always keep **even, consistent downward pressure** with right hand to ensure most accurate cut possible.
- 3 Blades are dull when you feel a crunching or dragging during cut or when you notice frayed V-Groover strips.
- 4 For maximum v-stop locking tension, make certain stop is firmly bottomed on backing sheet before tightening.
- 5 Do not attempt to adjust blade depth. The result will cause all settings to be inaccurate.
- 6 Use practice mat board to determine overcut settings for your Simplex V-Groover.
- 7 If V-Groover channel is not sharp and free of mat board debris, clean out with the tip of the blade.
- 8 After rotating mat for next cut, press down on stop foot to be sure that it is properly located behind end of mat board.

Troubleshooting

Problem	Reason	Solution
Inconsistent overcuts	Mat board may be out of square	Cut mat board square
	Moving stops by hitting them too hard	Hit stops gently
	Overcuts not adjusted properly	Re-adjust overcuts
Blade tip breaks	The blades are contacting each other or they are exposed	<ol style="list-style-type: none"> 1 Don't press both blade levers at the same time 2 Be sure both levers are up before beginning cutting process
Unparallel V-Groove	Cutter not riding flat	<ol style="list-style-type: none"> 1 Keep even downward pressure on base during cutting process 2 Guide rail must be flat on mat board
Rough, Frayed V-Groove	Dull or broken blade tip	Change blade or blades

Warranty

Logan Graphic Products, Inc. ("Logan") warrants the SIMPLEX V-GROOVER to be free from defects in parts and workmanship for a period of one year from the date of original purchase. Logan warrants that it will either repair or replace, in its sole discretion, any necessary replacement parts found to be defective. Should the product need to be returned to Logan for repair or replacement parts, authorization for any return must come from Logan in writing. Costs of returning the product to Logan, including insurances, shall be borne by the purchaser. Logan shall not be liable for any damages or losses, incidental or consequential, direct or indirect, arising from the use of this product. This warranty extends only to the original purchaser and is not assignable or transferable. This warranty is in lieu of all other warranties, expressed or implied.

SIMPLEX V-GROOVER

MODEL 703

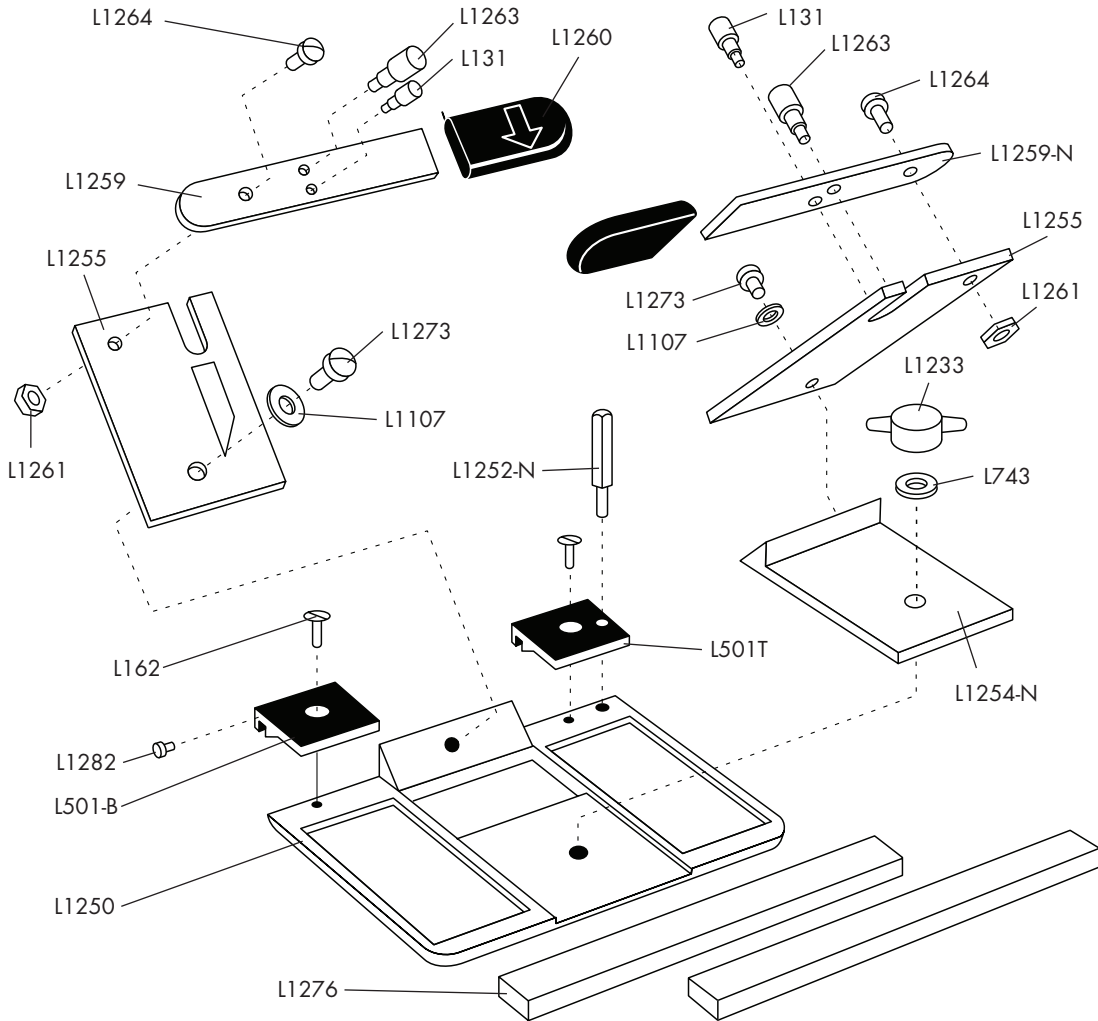

L1264	Screw	2
L1263	Upper Knurled Screw	2
L131	Lower Knurled Screw	2
L1259-N	Handle	2
L1260	Handle Sleeve	2
L1255	Blade Holder	2
L1261	Nut	2
L1273	Screw	2
L1107	Washer	1
L1233	Lock Lever	1
L743	Washer	1
L1254-N	Adjustable blade Handle	1
L1252-N	Overcut Adjustment Post	1
L162	Screw	2
L1282	Overcut Adjustment Screw	1
L501-B	Guide	1
L501-T	Guide	1
L1250	Base	1
L1276	Spacer bars	2
L1031	Scale	1

L1265	Stop Block	1
L1091	Washer	1
L1092	Washer	1
L366/367	Scale Lock Lever	1
L1084	Stop Lock Lever	1
L1266	Stop Foot	1
L1135	Stop Foot Screw	2
L1268	Clamp	1
L1270	Scale Bar	1

